

NEW

HYBRID

500lm

GRATI-LITE™

LE-SF501D-SP

FLOOD BEAM™

FLOOD BEAM™ is designed to produce bright light and makes it easy to see wiring and surface material

LED Detachable Work Light with belt clamping system

Common features to "SF" series

Use as a hand-held flashlight or as a work light

Swivel head to aim the light

GRATI-LITE™

LE-SF501D-SP

500lm

CLIP-n-HOLD

FLOOD BEAM™

Hybrid power source takes dedicated rechargeable battery (included) or AA batteries

Neodymium magnet can be attached to any ferromagnetic metal surface like steel

Can be attached facing up or down

Specifications

FL1 STANDARD	MODE 3	MODE 2	MODE 1	FL1 STANDARD	LE-SF501D-SP
	500 LUMENS	250 LUMENS	50 LUMENS		2m
	8h	12h	21h		307cd
	35m				83°

ITEM CODE	CASE	MASTER CARTON	UPC
LE-SF501D-SP	6	24	0-49296-26716-2

LITHIUM-ION BATTERY

ZP3730

3.7V

High-capacity, long-lasting battery

Voltage: 3.7V; Capacity: 3000mAh

ITEM CODE	CASE	MASTER CARTON	UPC
LE-ZP3730	1	96	0-49296-16558-1

Ideal Retail Display

Let us help you display and promote your Tajima products!

WIDE-ANGLE BEAM

Tajima GRATI-LITE™

FLOOD BEAM™

www.tajimatool.com

@tajimatoolusa

For more information, please contact our marketing department at orderdesk@tajimatool.com

Tajima

HOTNEWS

16

VOL.

Tajima TOOL CORPORATION 3510 Torrance Blvd., Suite 301, Torrance, CA 90503

Toll-Free Phone: 1-888-482-5462 www.tajimatool.com

© 2023 TAJIMA TOOL CORPORATION. ALL RIGHTS RESERVED.
No part of this publication may be reproduced, distributed, or transmitted in any form or by any means, without the prior written permission of the publisher.
Date of issue 1/1/2023

GRATI-LITE™

NEW LED Headlamp Series / 2-in-1 Detachable Work Light for construction

View Our Video

Tajima

GRATI-LITE™

LE-E502D-SP

NEW

HYBRID

500lm

GRATI-LITE™

LE-E502D-SP

FLOOD BEAM™

FLOOD BEAM™ is designed to produce bright light and makes it easy to see wiring and surface material

GRATI-LITE™

LE-E502D-SP

500lm

FLOOD BEAM™

Works with Li-ion rechargeable battery or AA batteries

Press the button to switch the lighting modes

Helmet clips

Specifications

FL1 STANDARD	MODE 3	MODE 2	MODE 1	FL1 STANDARD	LE-E502D-SP
	500 LUMENS	250 LUMENS	50 LUMENS		2m
	8h	12h	21h		307cd
	35m				83°

ITEM CODE	CASE	MASTER CARTON	UPC
LE-E502D-SP	6	24	0-49296-26710-0

LITHIUM-ION BATTERY

ZP3730

3.7V

High-capacity, long-lasting battery

Voltage: 3.7V; Capacity: 3000mAh

ITEM CODE	CASE	MASTER CARTON	UPC
LE-ZP3730	1	96	0-49296-16558-1

GRATI-LITE™
LE-SF351D

350_{lm}

CLIP-
n-
HOLD



- Safety Holder that can be attached to the vertical harness belt
- 3 modes of brightness: 15 lm → 150 lm → 350 lm
- Can be used as a work light
- Flicker-Free light
- A molded hole for lanyard attachments to prevent dropping
- Strong Neodymium magnet on the back

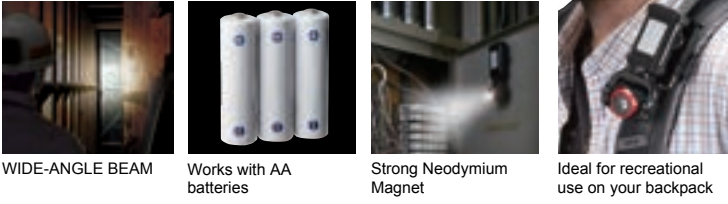

Specifications

FL1 STANDARD	MODE 3	MODE 2	MODE 1	FL1 STANDARD	LE-SF351D
	350 LUMENS	150 LUMENS	15 LUMENS		2m
	8h	20h	65h		2940cd
	108m				2m
				LIGHT DISTRIBUTION	
				Center Light Beam	
				Ambient Light Beam	
				24°	
				163°	

ITEM CODE	CASE	MASTER CARTON	UPC
LE-SF351D	6	24	0-49296-26681-3

Pick the LED LIGHT that best fits your needs

BEAM TYPE	LED LIGHTS SERIES	BATTERY
<p>Great for detailed work</p> <p>FLOOD BEAM™</p> <p>Lights up work clearly with an even luminosity. Fine wiring and surface of materials are visible closely, which is ideal for detailed work. This uniform light is easy on the eyes and less fatigue with low reflection.</p> <p>FLOOD BEAM™ Represents the angle at which the brightness of the light with an even luminosity from main body drops to 0%.</p>	LE-E502D-SP	HYBRID LE-ZP3730 or AA 1.5V x 4
	LE-F502D	AA 1.5V x 3
	LE-SF501D-SP	HYBRID LE-ZP3730 or AA 1.5V x 4
	LE-SF352D	AA 1.5V x 3
<p>Light up a large area</p> <p>WIDE-ANGLE BEAM</p> <p>The center beam emits the subject crisply and brightly, while the ambient beam shines on a wide area clearly from top to bottom. The spread light is ideal for work site or outdoor work with low-light condition to work safely.</p> <p>Center Beam Represents the irradiation angle until the brightness of the optical axis drops to 20%.</p> <p>Ambient Beam Represents the angle at which the brightness of the light emitted outside the center beam drops to 0%.</p>	LE-F501D	AA 1.5V x 3
	LE-M501D	AAA 1.5V x 3
	LE-SF351D	AA 1.5V x 3

2-in-1 Detachable
Handheld Flashlight & Work Light

350_{lm}
GRATI-LITE™
LE-SF352D



FLOOD BEAM™ is designed to produce bright light and makes it easy to see wiring and surface material

Common features to "SF" series

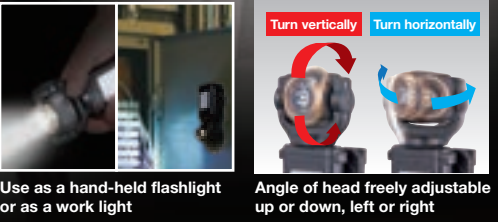

GRATI-LITE™
LE-SF352D

350_{lm}

CLIP-
n-
HOLD



AA 1.5V x 3
IPX4 2m

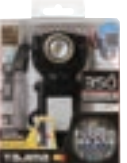

- FLOOD BEAM™ is ideal for work at hand with an even luminosity
- Safety Holder that can be attached to the vertical harness belt
- 3 modes of brightness: 15 lm → 150 lm → 350 lm
- Strong Neodymium magnet on the back
- Flicker-Free light
- A molded hole for lanyard attachments to prevent dropping

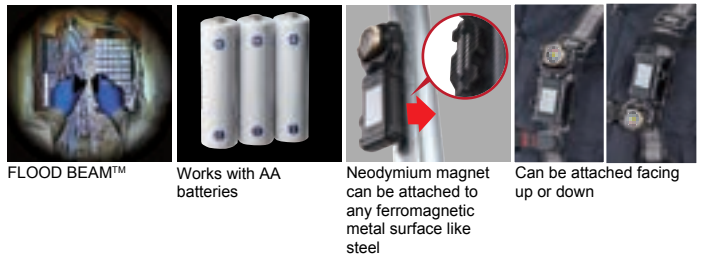

Specifications

FL1 STANDARD	MODE 3	MODE 2	MODE 1	FL1 STANDARD	LE-SF352D
	350 LUMENS	150 LUMENS	15 LUMENS		2m
	8h	20h	65h		225cd
	30m				2m
				LIGHT DISTRIBUTION	
				83°	

ITEM CODE	CASE	MASTER CARTON	UPC
LE-SF352D	6	24	0-49296-26717-9

500_{lm}
GRATI-LITE™
LE-F502D



FLOOD BEAM™ is designed to produce bright light and makes it easy to see wiring and surface material

GRATI-LITE™
LE-F502D

500_{lm}



AA 1.5V x 3
IPX4 2m



- FLOOD BEAM™ is ideal for work at hand with an even luminosity
- The external battery compartment can be easily opened or closed with gloves on
- 3 modes of brightness: 50 lm → 250 lm → 500 lm
- Over hard hat band fits nicely on the helmet
- Helmet clips prevent the light from slipping off during work
- Flicker-Free light

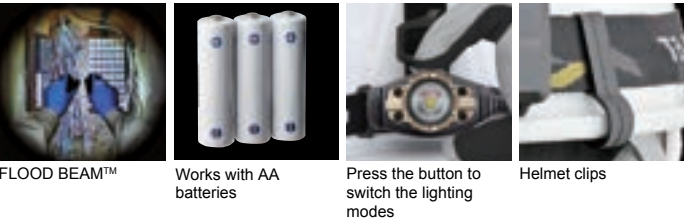

Specifications

FL1 STANDARD	MODE 3	MODE 2	MODE 1	FL1 STANDARD	LE-F502D
	500 LUMENS	250 LUMENS	50 LUMENS		2m
	6h	10h	25h		307cd
	35m				2m
				LIGHT DISTRIBUTION	
				83°	

ITEM CODE	CASE	MASTER CARTON	UPC
LE-F502D	6	24	0-49296-26709-4

GRATI-LITE™
LE-F501D

500_{lm}



AA 1.5V x 3
IPX4 2m



- Illuminated surface diameter is approximately 39.3 in (100 cm) when emitted at 19.6 in (50 cm) away from the subject
- The external battery compartment can be easily opened or closed with gloves on

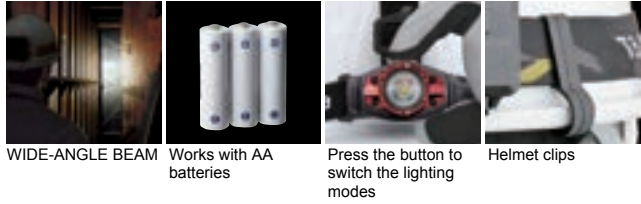

Specifications

FL1 STANDARD	MODE 3	MODE 2	MODE 1	FL1 STANDARD	LE-F501D
	500 LUMENS	250 LUMENS	50 LUMENS		2m
	6h	10h	25h		3480cd
	118m				2m
				LIGHT DISTRIBUTION	
				Center Light Beam	
				Ambient Light Beam	
				26°	
				165°	

ITEM CODE	CASE	MASTER CARTON	UPC
LE-F501D	6	24	0-49296-26679-0

GRATI-LITE™
LE-M501D

500_{lm}



AAA 1.5V x 3
IPX4 2m



- Illuminated surface diameter is approximately 36.6 in (93 cm) when emitted at 19.6 in (50 cm) away from the subject
- Strong Neodymium magnet on the back
- Detachable, rotate and slide mechanism
- Shut-off mode prevents accidental activation and battery depletion

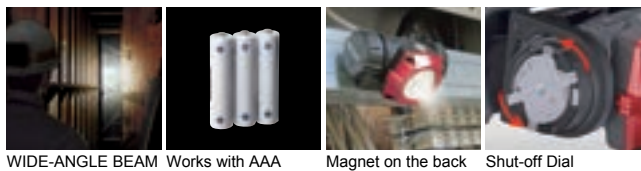

Specifications

FL1 STANDARD	MODE 3	MODE 2	MODE 1	FL1 STANDARD	LE-M501D
	500 LUMENS	250 LUMENS	50 LUMENS		2m
	4h	6h	15h		2500cd
	100m				2m
				LIGHT DISTRIBUTION	
				Center Light Beam	
				Ambient Light Beam	
				32°	
				86°	

ITEM CODE	CASE	MASTER CARTON	UPC
LE-M501D	6	24	0-49296-26680-6